

VSL CTT POT BEARINGS



DESIGN
ENGINEERING

TECHNICAL
SUPPORT

BEARING
FABRICATION

CE

VSL-CTT BEARINGS

Worldwide references in specialised bridge construction and experienced engineering

VSL-CTT Pot Bearings benefit of the VSL Expertise in structural engineering and construction methodologies. VSL Pot Bearings have been used worldwide on various prestigious projects for their innovative user-friendly design, reliability and quality.

The company

Subsidiary of the VSL Group, CTT-Stronghold is a leader in the field of post-tensioning and related engineering in Spain. In conjunction with VSL R&D teams a wide range of technically proven structural products have been developed over many years.

Structural bearings are important elements of structures, most notably in bridges, providing a connection between the superstructure and substructure.



VSL-CTT Bearing Technology

There are different types of bearings; one of the most widely used is the pot bearing due to its versatility and ingenious design.

Pot bearings are capable of transmitting forces while absorbing the structures deformations and rotations.

The strength of the bearing elastomer is maximized by encasing it in a pot and placing a piston on top.

Under vertical load, the elastomer behaves like a viscous fluid, allowing rotations around the horizontal axis.

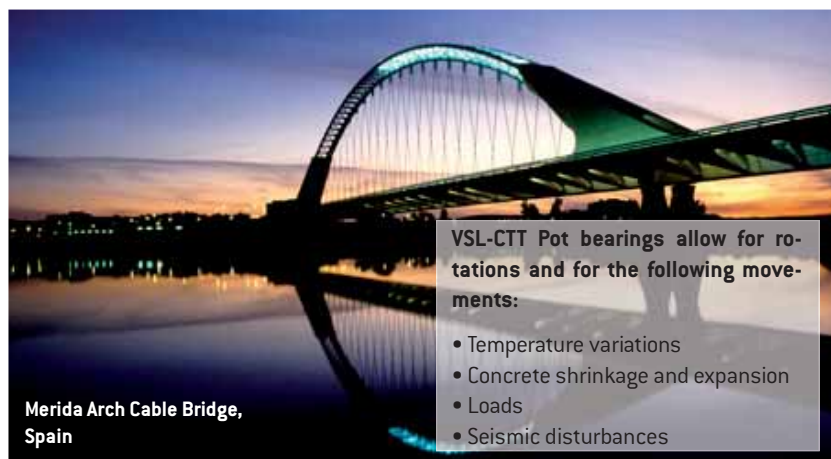

VSL's scope

Continuously trained VSL engineers propose tailor-made solutions within VSL's wide range of POT bearings to match the project's individual needs. As production processes for POT bearings are not standardized, the products will always be adapted to the even most challenging cases. At the factory, the quality of both factory production and testing are one of the main issues. Besides that VSL is the leader in short production time and fast delivery to the jobsites. – Depending on each country VSL's scope may include all steps from project consulting and installation of the bearings on site.



VSL-CTT Pot Bearings are made only from high-quality materials and designed to meet various codes and specifications.

COMPONENTS SPECIFICATIONS

High quality engineered solutions for every project

STAINLESS STEEL AND TOP PLATE

Transfers the vertical and horizontal load from the superstructure to the remaining parts of the bearing.

P.T.F.E. ¹

Transfers the vertical load from the top plate to the piston and provides a low-friction surface against the sliding surface of the upper plate during movement.

EXTERNAL SEALING RING

Prevents moisture and debris from entering the gap between the piston and the pot.

GUIDE² AND PISTON OF DU METAL

Transfers the horizontal load from the recess of the top plate to the pot and the vertical load to the elastomer.

A recess on the surface of the piston confines the PTFE.

INTERNAL SEALING RING

Prevents the extrusion of the Elastomer.

ELASTOMER PAD

Transfers the vertical load from the piston to the pot and allows the bearing to rotate.

POT (STEEL RING + BASE PLATE)

Confines the elastomer and eventually transfer vertical and horizontal loads to the substructure and bolts, respectively.

BOLTS AND SOCKETS

Resist horizontal loads.

1. For free and guided bearings only
2. For guided bearings only

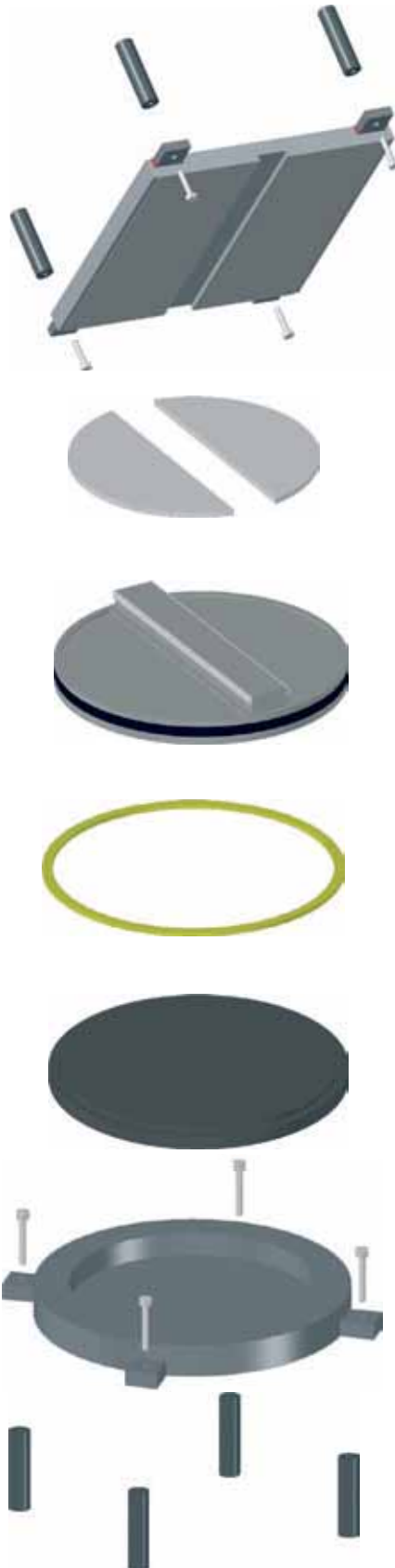

VSL-CTT Pot Bearings meet the industry's highest quality requirements.

CE MARK



VSL-CTT Pot bearings are CE approved.

The quality of the materials and workmanship are ensured by Quality Control Plans regularly audited and revised to meet any particular specification.

CORROSION PROTECTION



Steel areas exposed to the atmosphere are protected with a corrosion protection system in accordance with projects requirements and / or relevant international standards.

TESTING



The quality and conformity behaviour of VSL-CTT Pot Bearings are regularly checked at accredited test laboratories with:

- Vertical load tests
- Combined vertical and horizontal load tests
- Friction tests

STANDARD VSL-CTT POT BEARINGS:

Providing the best solutions to meet the client's requirements



PF Type bearings can resist horizontal loads in both longitudinal and transverse directions, hence, does not allow any movement.

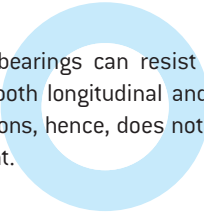

High Speed Railway Bujaraloz, Spain



PU Type bearings allow movement in one direction and can resist horizontal loads perpendicular to the direction of movement

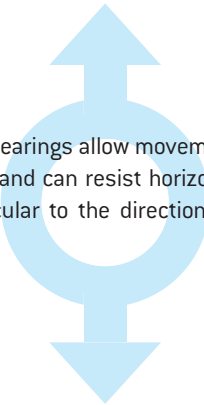

Pont de Lully, Switzerland



PL Type bearings allow movement in both longitudinal and transverse directions, hence, does not resist horizontal loads except for nominal friction.

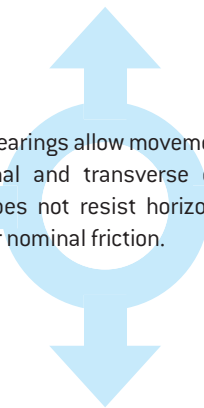

River Miño Bridge - Spain

CE MARK

VSL-CTT Pot bearings are designed in accordance to the most important standards worldwide:

- AASHTO – American Association of State Highway and Transport Officials
- BS 5400 – British Standard – Section 9.1 and 9.2
- EN 1337 – European Norm

All bearings designed and manufacturing according to Euronorm are CE Marked.



The flexibility of VSL-CTT Pot Bearings allow a most flexible freedom for design and construction.

SPECIAL POT BEARINGS:

Tailormade for even the most challenging project

VSL-CTT manufactures special tailor-made Pot Bearings designed to fit particular technical specifications and requirements of individual projects.

VSL-CTT offers a wide range of technical solutions for the design of special Pot Bearings.

VSL-CTT technical department has the capability to develop innovative alternatives to standard products.

The wide and elaborated range of VSL Pot Bearings and their advantageous under one roof manufacture make them to be a preference for any demanding bridge project.

ILM POT BEARING

- Bearings with low friction surface for the sliding of structures using the Incremental Launching Method.
- Bearings are temporary and permanent with significant cost saving.

ILM Pot bearing



LOAD CELL POT BEARING

- Bearings with electronic transducers for the monitoring of the vertical load.
- Data loads can be collected manually or automatically (optional).



ACCESSORIES

To meet the most stringent requirements

ANTI-DUST SKIRT

As the name suggests, this device is installed to protect the sliding surfaces of the bearing from dust which could affect the friction coefficient.

This is recommended for both PL and PU bearing types.

The neoprene skirts are attached to the top plate of the bearing through a metal ruler.

BEARING WITH ELECTRICAL ISOLATION

- Bearings with electrical isolation to avoid the pass of the electricity through the bearing.
- Required on some countries for Railway bridges.

MOVEMENT INDICATOR

This apparatus is designed to measure the horizontal movements of the bearing and indicate pre-setting.



DESIGN OF POT BEARINGS

Our Technical Department is available to supply any specific information in order to assist designers from the early conceptual stage.

It should be pointed out that the cost of Pot bearings varies with the changes in design parameters.

For instance, the allowable bearing pressure on the concrete has a major influence. It is advised that bursting reinforcement should be designed and incorporated in concrete bearing seating areas to enhance its bearing capacity.

This will significantly reduce the size of

the bearings, which, in most cases result in savings.

To assess the optimum Pot Bearing dimensions for your application and to carry out a detailed design, please contact your local VSL-CTT office.

TECHNICAL DATA SHEETS

Design of Pot Bearings can be substantially influenced by local codes and projects requirements. VSL-CTT Pot bearings datasheets are available for design according to a variety of International Codes of designs and Practices.

Dimensions given in the following technical data sheets are indicative, representing a pre-sizing of the three different types of Pot bearings. They are given to make the design engineer's work easier and should be used with caution,

bearing in mind that they are calculated from the design assumptions table stated in the relevant Design code Technical datasheet. For other combinations of loadings and movements, please contact a VSL-CTT representative in your area.

VSL can offer the complete package

VSL does not only install bearings on new project, but can also advice you on replacement, maintenance and condition evaluation of existing bearings.

When replacing bearings VSL Heavy Lifting has the know-how and experinece to provide an economic and suitable solution. The approach of VSL Heavy Lifting Engineers is flexible and the range of services is tailored to the specific project requirements.

VSL-CTT bearings are also available on other types as elastomeric or spherical



For decades, VSL-CTT Pot Bearings have proven their reliability and durability in hundreds of references throughout the world. VSL-CTT know-how and experience is the best base for future projects.

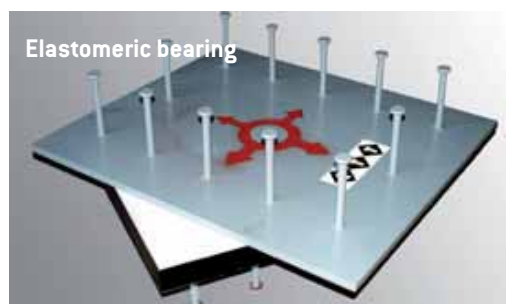



HEADQUARTERS SPAIN

VSL / CTT-STRONGHOLD, S.A.
BARCELONA

Phone: +34 93 289 23 30
Fax: +34 93 289 23 31

ALL YOU NEED IN BEARING'S TECHNOLOGY

VSL LOCATIONS

Americas

ARGENTINA

VSL Sistemas Especiales de Construcción Argentina S.A.
BUENOS AIRES
Phone: +54 11 4326 06 09
Fax: +54 11 4326 26 50

BOLIVIA

Postensados de Bolivia
San Miguel, LA PAZ
Phone: +591 2 27 70 338
Fax: +591 2 27 96 183

CHILE

VSL Sistemas Especiales de Construcción S.A.
SANTIAGO
Phone: +56 2 571 67 00
Fax: +56 2 571 67 01

COLOMBIA

Sistemas Especiales de Construcción S.A.S.
BOGOTA
Phone: +57 1 226 62 30
Fax: +57 1 271 50 65

MEXICO

VSL Corporation Mexico S.A. de C.V.
MEXICO
Phone: +52 55 55 11 20 36
Fax: +52 55 55 11 40 03

PERU

Sistemas Especiales de Construcción Peru S.A.
LIMA
Phone: +51 1 349 38 38
Fax: +51 1 348 28 78

UNITED STATES

VStructural LLC
BALTIMORE, MD
Phone: +1 410 850 7000
Fax: +1 410 850 4111

VENEZUELA

Gestión de Obras y Construcciones C.A.
CARACAS
Phone: +58 212 941 86 75
Fax: +58 212 941 86 75

Asia

BRUNEI

VSL Systems (B) Sdn. Bhd.
BRUNEI DARUSSALAM
Phone: +673 2 380 153 / 381 827
Fax: +673 2 381 954

CHINA PRC

VSL (China) Engineering Corp., Ltd.
HEFEI
Phone: +86 551 382 29 18
Fax: +86 551 382 28 78

HONG KONG

VSL Hong Kong Ltd.
CHAI WAN
Phone: +852 2590 22 88
Fax: +852 2590 02 90

Intrafor Hong Kong Ltd.
CHAI WAN
Phone: +852 2836 31 12
Fax: +852 2591 61 39

FT Laboratories Ltd
PING CHE
Phone: +852 2758 48 61
Fax: +852 2758 89 62

INDIA

VSL India Private Ltd.
CHENNAI
Phone: +91 44 4225 11 11
Fax: +91 44 4225 10 10

INDONESIA

PT VSL Indonesia
JAKARTA
Phone: +62 21 570 07 86
Fax: +62 21 573 75 57

JAPAN

VSL Japan Corporation
TOKYO
Phone: +81 3 3346 8913
Fax: +81 3 3345 9153

KOREA

VSL Korea Co. Ltd.
SEOUL
Phone: +82 2 553 8200
Fax: +82 2 553 8255

MALAYSIA

VSL Engineers (M) Sdn. Bhd.
Kuala Lumpur
Phone: +60 3 7981 4742
Fax: +60 3 7981 8422

PHILIPPINES

VSL Philippines Inc.
PASIG City
Phone: +632 723 13 95
Fax: +632 723 13 95

SINGAPORE

VSL Singapore Pte. Ltd.
SINGAPORE
Phone: +65 6559 12 22
Fax: +65 6257 77 51

TAIWAN

VSL Taiwan Ltd.
TAIPEI
Phone: +886 2 2759 68 19
Fax: +886 2 2759 68 21

THAILAND

VSL (Thailand) Co. Ltd.
Bangkok
Phone: +66 2 679 76 15 - 19
Fax: +66 2 679 76 45

VIETNAM

VSL Vietnam Ltd.
HANOI
Phone: +84 4 3976 5088
Fax: +84 4 3976 5089

Ho Chi Minh City
Phone: +84 8 810 6817
Fax: +84 8 810 6818

Australia

VSL Australia Pty Ltd
NEW SOUTH WALES
Phone: +61 2 9484 5944
Fax: +61 2 9875 3894

QUEENSLAND

Phone: +61 7 3265 64 00
Fax: +61 7 3265 75 34

VICTORIA

Phone: +61 3 979 503 66
Fax: +61 3 979 505 47

SOUTH AUSTRALIA

Phone: +61 8 8354 4884
Fax: +61 8 8354 4883

TASMANIA

Phone: +61 3 6225 3567
Fax: +61 3 6225 2226

PERTH

Phone/Fax: +61 8 9523 4686

Europe

AUSTRIA

Grund-Pfahl- und Sonderbau GmbH
HIMBERG
Phone: +43 2235 87 777
Fax: +43 2235 86 561

CROATIA

Tehni ki projekt d.o.o.
10000 Zagreb
Phone: +385 1 4664 586
Fax: +385 1 4664 549

CZECH REPUBLIC

VSL SYSTEMS (CZ) Ltd.
PRAGUE
Phone: +420 2 51 09 16 80
Fax: +420 2 51 09 16 99

FRANCE

VSL France S.A.
LABÈGE
Phone: +33 05 61 00 96 59
Fax: +33 05 61 00 96 62

GERMANY

VSL Systems GmbH
BERLIN
Phone: +49 30 53 028 060
Fax: +49 30 53 028 0699

GREAT BRITAIN

VSL Systems (UK) Ltd.
BEDFORDSHIRE
Phone: +41 58 456 30 30
Fax: +41 58 456 30 35

NETHERLANDS

Heijmans Beton en Waterbouw B.V.
ROSMALEN
Phone: +31 73 543 66 02
Fax: +31 73 543 66 11

NORWAY

SPENNARMERING NORGE AS
RUD
Phone: +47 98 21 02 66
Fax: +47 67 17 30 01

PORTUGAL

VSL Sistemas Portugal
Pre-Esforço, Equipamento e Montagens SA
S. DOMINGOS DE RANA
Phone: +351 21 445 83 10
Fax: +351 21 444 63 77

VSL GEO

Sistemas de Aplicação em Geotecnia SA
S. DOMINGOS DE RANA
Phone: +351 21 445 83 10
Fax: +351 21 445 83 28

SPAIN

CTT Stronghold
BARCELONA
Phone: +34 93 289 23 30
Fax: +34 93 289 23 31

VSL-SPAM, S.A.

BARCELONA
Phone: +34 93 846 70 07
Fax: +34 93 846 51 97

SWEDEN

Internordisk Spännarmring AB
VÄSTERHANINGE
Phone: +46 10 448 74 29
Fax: +46 8 753 49 73

SWITZERLAND

VSL (Switzerland) Ltd.
SUBINGEN
Phone: +41 58 456 30 30
Fax: +41 58 456 30 35

VSL (Suisse) SA

SAINT LEGIER
Phone: +41 58 456 30 00
Fax: +41 58 456 30 95

TURKEY

MEGA YAPI Construction & Trade Co. Ltd.
ANKARA
Phone: +90 312 490 90 66
Fax: +90 312 490 90 55

Africa

EGYPT

Matrix Engineering Company
CAIRO
Phone: +20 2 344 19 00
Fax: +20 2 346 04 57

SOUTH AFRICA

Tsala-RMS Construction Solutions (Pty) Ltd
JOHANNESBURG
Phone: +27 11 878 6820
Fax: +27 11 878 6821

Middle East

UNITED ARAB EMIRATES

VSL Middle East LLC
DUBAI, UAE
Phone: +971 4 885 7225
Fax: +971 4 885 7226

Syria

Kahaleh for consulting engineering
DAMASCUS
Phone: +963 11 23 24 702
Fax: +963 11 22 14 595

DOHA, QATAR

Phone: +974 423 1117
Fax: +974 423 1100